

System 8750XD 3" x 7 1/2" Unitized Curtain Wall with Duracast® Fiberglass



CONFIGURATIONS

2 or 4-sided Captured/Pressure Glazed • 2 or 4-sided Structural Silicone Glazed

EFCO's 8750XD Unitized Curtain Wall is the latest addition to our XTherm® family of products. It utilizes Duracast® fiberglass composite technology in a patent pending thermal break design, which provides outstanding thermal performance without sacrificing structural integrity. The 8750XD offers an industry leading U-Factor which is not compromised when the 875X Wall Vent is added. The combination of popular system profiles, dry glazed or 2 & 4 sided SSG, and integral vents, offers outstanding design and flexibility. While improved manufacturability with fewer parts and pieces, simplifies fabrication and ease of installation.

Features

3" Sightlines

7-1/2" system depth

Patented Duracast® Thermal Break

90° Inside and outside corners

Triple glazed performance with double glazing

Integral vent options (875X)

Dry glazed

U-Factor of .30 with .24 COG glass

Frame CRF of 82

Rain screen design

+/- 1/2" movement

Estimated 45% reduction of fabrication

Up to 1-1/4" glazing infill

Thermal door frames

Benefits

Commonly accepted profile

Designed for 12 ft slab to slab spans

Provides industry leading U-Factor of .30

Allows for uninterrupted ribbons

Less cost and weight

Tenant controlled ventilation

Reduced fabrication

Industry leading thermal performance

Increased resistance to condensation

Minimum 15 lbs. water resistance

Allows for construction tolerance & movement

Cost reduction

Increased spandrel & vision glazing options

Full system performance

System 8750XD 3" x 7 1/2" Unitized Curtain Wall with Duracast® Fiberglass

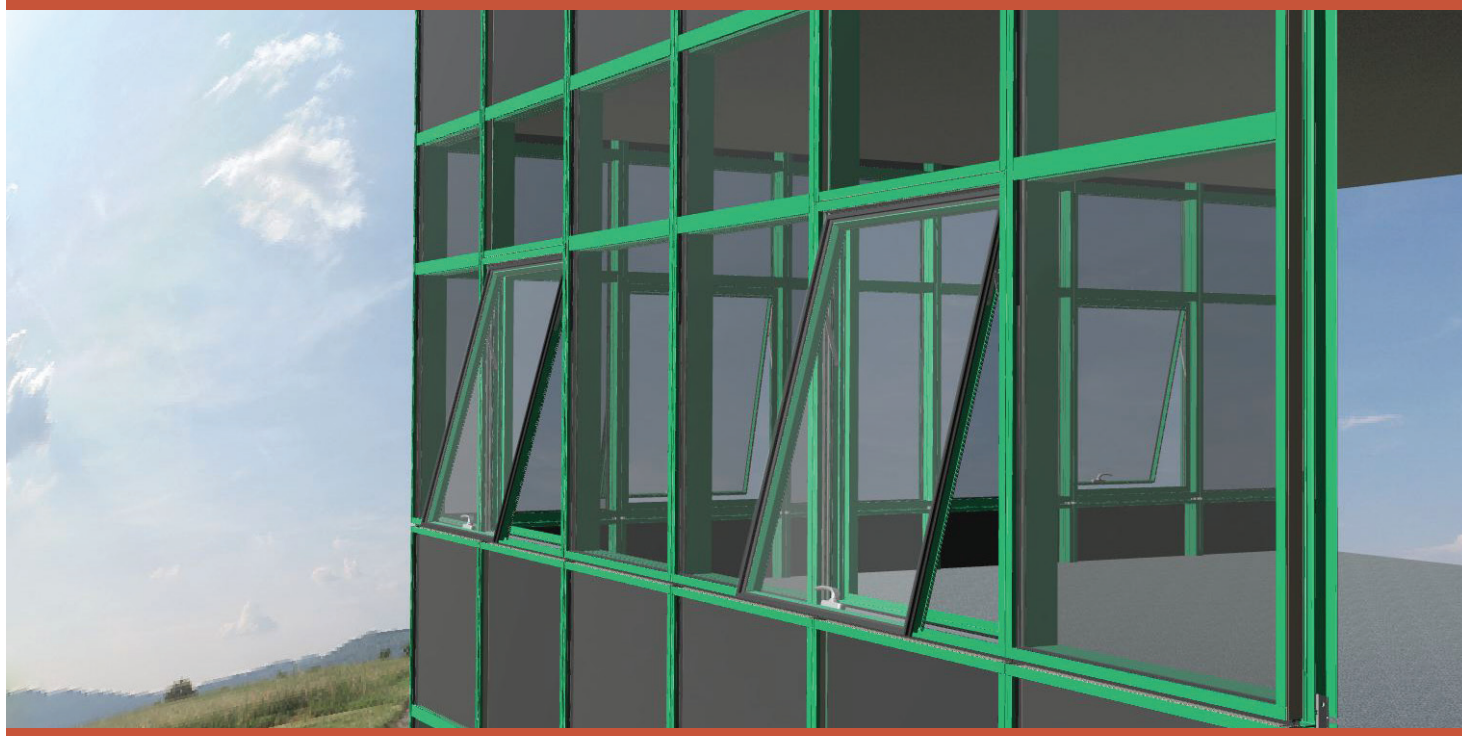

PERFORMANCE DATA

SERIES 8750 UNITIZED CURTAIN WALL (CAPTURED)

AIR INFILTRATION <.06 @ 6.24 PSF
WATER 15.0 PSF
STRUCTURAL ± 75 PSF
CRF-FRAME 82

SERIES 8750 UNITIZED CURTAIN WALL (SSG)

AIR INFILTRATION <.06 @ 6.24 PSF
WATER 15.0 PSF
STRUCTURAL ± 75 PSF
CRF-FRAME 79

Note: All performance value data is based on laboratory testing per AAMA 101/I.S.2/A440 for Air/Water/Structural, ASTM E90 and or E413 for Acoustical, AAMA 507 and or NFRC 100/200/500 for UFactors and AAMA 1503 for Condensation Resistance Factor (CRF). Printed values are subject to change pending the frequency of recertification testing. Field results will vary depending on size, the field test method, the addition of sub-frames, panning, mullions, accessories and installation into the surrounding condition.

8750XD GLAZING CHART	GLASS OR PANEL		
	1-3/4"	2"	2-1/4"
OUTSIDE GLAZED	A	S	A

A-Available Glazing Option
S-Standard Glazing
Blank - N/A

8750XD THERMAL U-FACTORS*		
CENTER OF GLASS U-FACTOR	CONFIGURATION AND SIZE	
	CAPTURED 78 3/4" X 78 3/4"	SSG 78 3/4" X 78 3/4"
0.46	0.49	0.51
0.34	0.39	0.40
0.30	0.35	0.37
0.24	0.30	0.32
0.20	0.27	0.28

* Based on NFRC 100

**NFRC Gateway size

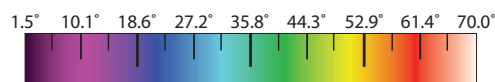
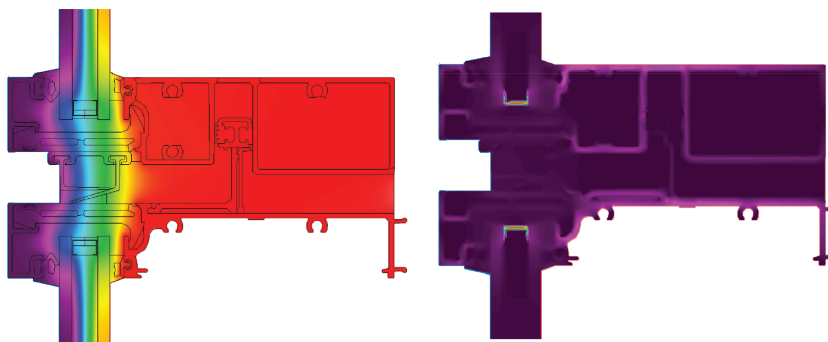

Interior Frame Temp. Comparisons

Interior Temp = 70° F

Exterior Temp = 0° F

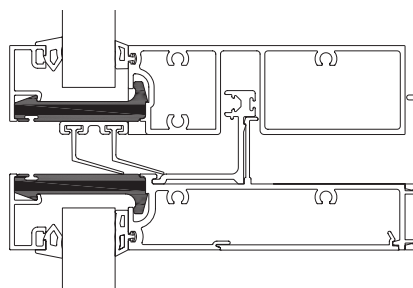



System 8750XD 3" x 7 1/2" Unitized Curtain Wall with Duracast® Fiberglass

Main Frame Construction

Frame members for this 3" x 7 1/2" system are made from extruded 6063-T6 aluminum alloy with a nominal wall thickness of .100". Corner construction employs screw spline joinery methods. See Illustration 1

Concealed Vent Construction

Series 8750 Unitized offers an integral vent (875X) for interior comfort

Thermal Barrier

The patented Duracast® thermal break provides industry leading thermal performance.

Door Frame Integration

Series 8750 Unitized incorporates an intergral door framing system that can be installed after the unitized module is set. This allows for all unitized construction to complete prior to installing entrances.



Illustration 1

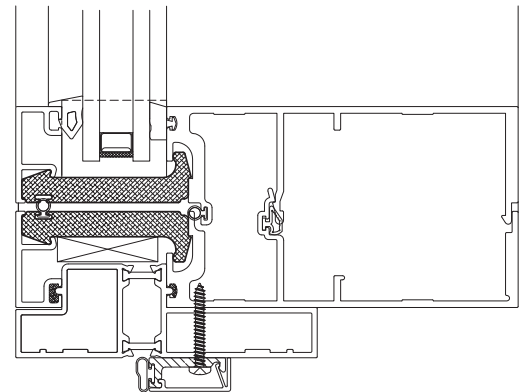

Illustration 2